

SECTION A-A

\* TURNING LANES:

ON NEW CONSTRUCTION OR GRADE WIDENING,  
A 3.5m TURNING LANE WITH 1.5m SHOULDER  
IS TO BE PROVIDED ON THE RIGHT HAND SIDE.  
A 3.5 m TURNING LANE WITH 0.5 m SHOULDER  
IS TO BE PROVIDED FOR THE LEFT HAND (MEDIAN) SIDE.

ON EXISTING ROADWAYS IF A SUFFICIENT SHOULDER WIDTH  
IS AVAILABLE A MINIMUM 3.0m TURNING LANE WITH  
A MINIMUM 0.3m SHOULDER MAY BE PROVIDED BY MEANS  
OF PAVEMENT MARKINGS. WHERE ADDITIONAL SHOULDER WIDTH  
IS AVAILABLE THE TURNING LANE WIDTH CAN BE  
INCREASED TO 3.5m.

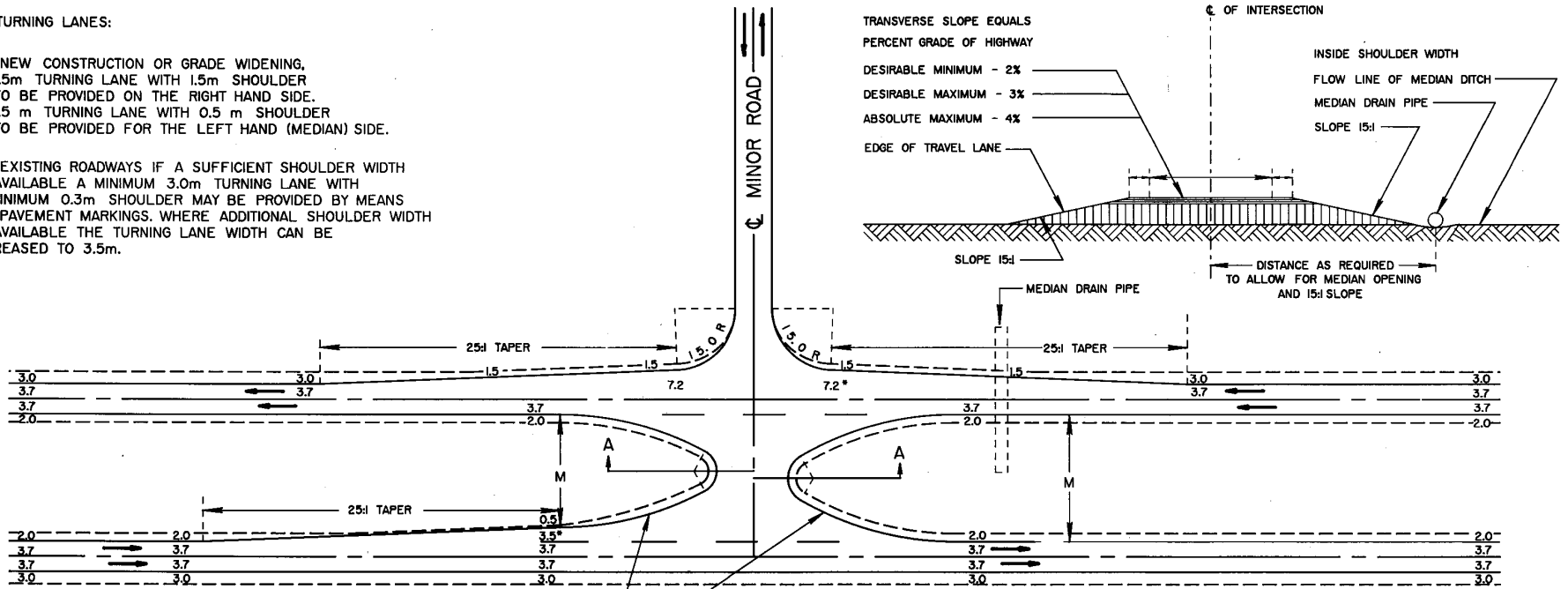

FOR DETAILS OF BULLET NOSE  
DESIGN, REFER TO SECTION C.8.4  
OF THE DESIGN MANUAL.

NOTES:

1. ALL DIMENSIONS SHOWN ARE FOR FINISHED PAVEMENT SURFACES.
2. EXTRA SUBGRADE WIDTH SHALL BE PROVIDED DURING GRADING TO ALLOW FOR DEPTH OF BASE COURSE AND SURFACING.
3. MAJOR ROAD REFERS TO ALL TWO-LANE HIGHWAYS, SECONDARY HIGHWAYS, TOWN ACCESS ROADS, AND PARK ACCESS ROADS.

△			
△			
No.	REVISIONS	BY	DATE

Approved: 

Director,  
Design Engineering Branch

Date: MARCH 25, 1993

**Alberta**  
TRANSPORTATION  
AND UTILITIES  
Engineering Division

MINOR "T" INTERSECTION  
ON FOUR LANE  
DIVIDED HIGHWAYS

Prepared By: L.T.	Checked By: P.K.	Scale: N.T.S.	Dwg No.: CB6-2.3 C60
-------------------	------------------	---------------	----------------------

GRAPHICS FILE: DEH200,22\DEB\F060.DGN