



WORKSPACE LEGEND

ELECTRICAL/VOICE/DATA LEGEND (TYPICAL):

 DUPLEX OUTLET

 VOICE/DATA

 POWER FEED

NOTE:

1. PROVIDE ALL NECESSARY ELECTRICAL AND POWER HARNESSSES/CABLING REQUIRED.
2. IN PANELED WORKSPACES, LOCATE ELECTRICAL IN BASE. PROVIDE CABLE MANAGEMENT.

PANELS:

PANELS SHALL BE COMPRISED OF 1 (ONE) MANUFACTURER'S STANDARD HEIGHT BASE PANEL AND 1 (ONE) LOAD BEARING STACKED PANEL TO ACHIEVE AN OVERALL HEIGHT OF 54"± (1372 mm±) TO 60" (1524mm).

PANEL WIDTHS SHALL BE 24" (610mm) , 30" (762mm), 42" (1067mm), OR 48" (1219mm) AS REQUIRED TO ACHIEVE THE OVERALL LAYOUT.

BASE PANEL HEIGHT MUST BE 34" (864mm) MINIMUM TO 42" (1067mm) MAXIMUM.

NOTE:

DRAWINGS TO BE READ IN CONJUNCTION WITH THE TECHNICAL DESIGN REQUIREMENTS (TDR).

OPTIONAL: GLASS MAY BE ADDED BASED ON PROJECT REQUIREMENTS.

ANY DISCREPANCIES SHALL BE BROUGHT TO THE ATTENTION OF TECHNICAL SERVICES.

KIT OF PARTS LEGEND:

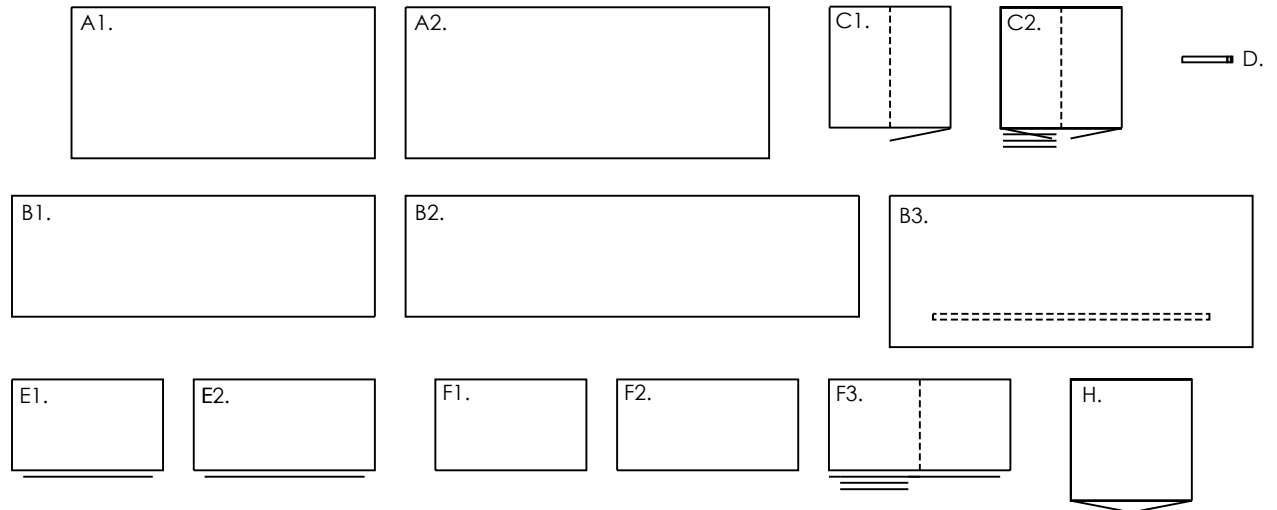

KIT- OF-PARTS DESCRIPTION:

- A1: PRIMARY WORKSURFACE 30"D x 60"W (762 mm D x 1524 mm W)
A2: PRIMARY WORKSURFACE 30" D x 72" W (762 mm D x 1829 mm W)
B1: SECONDARY WORKSURFACE 24" X 60" (610mm D x 1524 mm W)
B2: SECONDARY WORKSURFACE 24" D x 90" W (610 mm D x 2286 mm W)
B3: SECONDARY WORKSURFACE 30" D x 72" W (610 mm D x 1829 mm W)
C1: OPEN/CLOSED INTEGRATED WARDROBE AND STORAGE TOWER- 24" W x 24" D x 54"± H (610 mm W x 610 mm D x 1372 mm ± H)
C2: CLOSED INTEGRATED WARDROBE AND STORAGE TOWER 24" W x 24" D x 72"± H (610 mm W x 610 mm D x 1829 mm ± H)
D: COAT HOOK- OVER PANEL
E1: LOW FILE STORAGE- 30" W x 18" D x 27"± H (762 mm W x 457 mm D x 686 mm ± H)
E2: LOW FILE STORAGE- 36" W x 18" D x 27"± H (914 mm W x 457 mm D x 686 mm ± H)
F1: LOW OPEN STORAGE- 30" W x 18" D x 27"± H (762 mm W x 457 mm D x 686 mm ± H)
F2: LOW OPEN STORAGE- 36" W x 18" D x 27"± H (914 mm W x 457 mm D x 686 mm ± H)
F3: LOW COMBINATION STORAGE- 36" W x 18" D x 27" ± H (914 mm W x 457 mm D x 686 mm ± H)
G1: DESK HEIGHT TABLE- 36" Dia. (914 mm Dia.)
G2: DESK HEIGHT TABLE- 42" Dia. (1067 mm Dia.)
H: CLOSED COMBINATION WARDROBE AND STORAGE CABINET- 24" D x 24" W x 72" H (610 mm D x 610 mm W x 1829mm H)

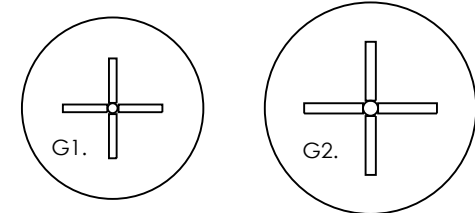

	CONSULTANT		PROJECT		DRAWN BY	CHECKED BY	SCALE
	DOCUMENT CODE WORKSPACE FURNITURE TYPICALS_APPENDIX I_TDR.V8_2025		TECHNICAL DESIGN REQUIREMENTS VERSION 8		JH	KM	NTS
			TITLE		DATE	SITE ID	BUILDING ID
			TYPICAL WORKSPACE- LEGEND AND NOTES		02-21-2025	-	-
				PLAN NO.	PHASE	DISCIPLINE	
				-	-	-	
				PROJECT ID.		SHEET NO.	
				Appendix I		A	

DOCUMENT CODE
WORKSPACE FURNITURE TYPICALS_APPENDIX I_TDR.V8_2025



Al.	
-----	--

1. REFER TO LEGEND SHEET A, AND SECTION 3 OF THE TECHNICAL DESIGN REQUIREMENTS.
2. TYPICAL PANEL THICKNESS IS $3'' \pm (76 \text{ mm} \pm)$ AS PER MANUFACTURER'S STANDARD.
3. AS COMMON PANELS ARE SHARED WHEN THEY ARE GANGED TOGETHER, THE AREA FOR AN INDIVIDUAL WORKSPACE IS BASED ON THE CENTERLINE OF THE PANEL.
4. WORKSURFACES AND STORAGE SHALL HAVE DIMENSIONAL LOGIC AND CONSISTENCY.
5. ALL WORKSURFACES TO BE FREE-STANDING (NON-PANEL HUNG).
6. CHAIRS ARE SHOWN FOR ILLUSTRATION ONLY.
7. OPTIONAL: GLASS MAY BE ADDED BASED ON PROJECT REQUIREMENTS.

CLEAR OR FROSTED SINGLE PANE GLASS - FRAMELESS (ACRYLIC IS NOT ACCEPTABLE)
 PANEL FABRIC: GRADE 2/B FABRIC
 TOP, END & CORNER TRIMS: FULL-LENGTH, STANDARD PAINTED METAL FINISH
 (INCLUDES METALLIC OPTIONS)

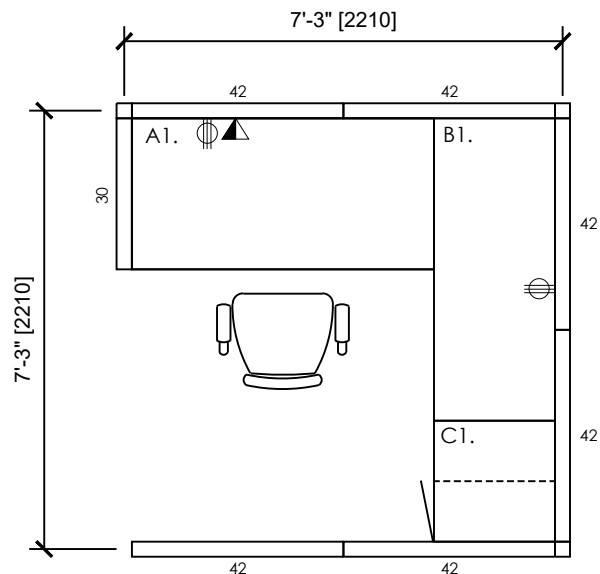

2 STANDARD WORKSPACE
4.9 m²

WORKSTATION FINISHES:

WORKSURFACE TOPS: H.P. PLASTIC LAMINATE C/W
STANDARD MATCHING EDGE

LAMINATE: STANDARD GRADE (INCLUDES WOOD GRAIN
LAMINATE OPTIONS)

LEGS/BASE: STANDARD PAINTED METAL FINISH (INCLUDES
METALLIC OPTIONS)

STORAGE TOWER: LAMINATE OR STANDARD PAINTED
METAL FINISH

STANDARD PULL: (BARRIER-FREE COMPLIANT)

PANEL FINISHES:

CLEAR OR FROSTED SINGLE PANE GLASS - FRAMELESS (ACRYLIC
IS NOT ACCEPTABLE)

PANEL FABRIC: GRADE 2/B FABRIC

TOP, END & CORNER TRIMS: FULL-LENGTH, STANDARD
PAINTED METAL FINISH (INCLUDES METALLIC OPTIONS)

WORKSPACE KIT-OF-PARTS LEGEND:

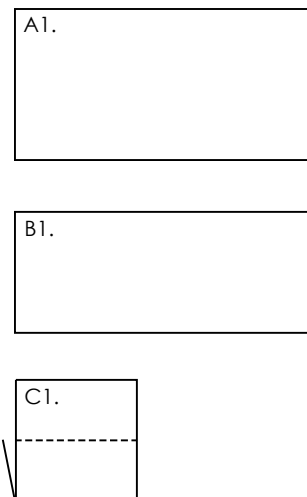

A1. PRIMARY WORKSURFACE

- 30" D x 60" W (762 mm D x 1524 mm W)
- ELECTRIC HEIGHT ADJUSTABLE. DUAL STAGE, PROGRAMMABLE CONTROLLER
- CABLE MANAGEMENT ALONG BACK

B1. SECONDARY WORKSURFACE

- 24" D x 60" W (610 mm D x 1525 mm W)
- PIN HEIGHT ADJUSTABLE POST LEGS (C-LEGS OPTIONAL)
- CABLE MANAGEMENT ALONG BACK

C1. OPEN/CLOSED INTEGRATED WARDROBE AND STORAGE TOWER

- 24" W x 24" D x 54"± H (610 mm W x 610 mm D x 1372 mm ± H)
- FULL WARDROBE WITH COAT ROD INCLUDED
- BOX BOX FILE WITH OPEN SHELVING ABOVE FACING WORKSURFACE B1.
- ANTI-TIP
- SIMILAR OVERALL HEIGHT AS STACKED PANEL

GENERAL NOTES

1. REFER TO LEGEND SHEET A, AND SECTION 3 OF THE TECHNICAL DESIGN REQUIREMENTS.
2. TYPICAL PANEL THICKNESS IS 3"± (76 mm ±) AS PER MANUFACTURER'S STANDARD.
3. AS COMMON PANELS ARE SHARED WHEN THEY ARE GANGED TOGETHER, THE AREA FOR AN INDIVIDUAL WORKSPACE IS BASED ON THE CENTERLINE OF THE PANEL.
4. WORKSURFACES AND STORAGE SHALL HAVE DIMENSIONAL LOGIC AND CONSISTENCY.
5. ALL WORKSURFACES TO BE FREE-STANDING (NON-PANEL HUNG).
6. ALL STORAGE TO BE LOCKABLE AND KEYED ALIKE.
7. CHAIRS ARE SHOWN FOR ILLUSTRATION ONLY.
8. OPTIONAL: GLASS MAY BE ADDED BASED ON PROJECT REQUIREMENTS.

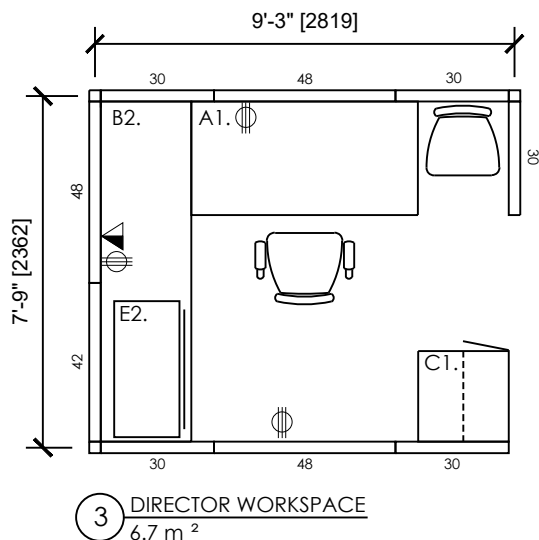

WORKSTATION FINISHES:

WORKSURFACE TOPS: H.P. PLASTIC LAMINATE C/W STANDARD MATCHING EDGE

LAMINATE: STANDARD GRADE (INCLUDES WOODGRAIN LAMINATE OPTIONS)

LEGS/BASE: STANDARD PAINTED METAL FINISH (INCLUDES METALLIC OPTIONS)

STORAGE TOWER: LAMINATE OR STANDARD PAINTED METAL FINISH

STANDARD PULL (BARRIER-FREE COMPLIANT)

LOW STORAGE:

LAMINATE OR STANDARD PAINTED METAL FINISH

STANDARD PULL (BARRIER-FREE COMPLIANT)

PANEL FINISHES:

CLEAR OR FROSTED SINGLE PANE GLASS - FRAMELESS (ACRYLIC IS NOT ACCEPTABLE)

PANEL FABRIC: GRADE 2/B FABRIC

TOP, END & CORNER TRIMS: FULL LENGTH, STANDARD PAINTED METAL FINISH (INCLUDES METALLIC OPTIONS)

WORKSPACE KIT-OF-PARTS LEGEND:

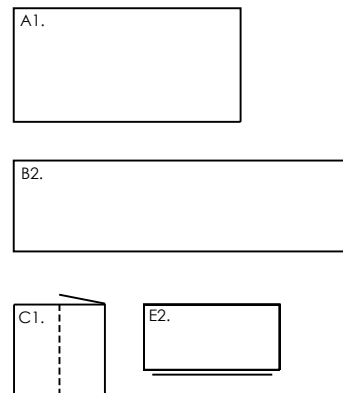

GENERAL NOTES

1. REFER TO LEGEND SHEET A, AND SECTION 3 OF THE TECHNICAL DESIGN REQUIREMENTS.
2. TYPICAL PANEL THICKNESS IS 3"± (76 mm ±) AS PER MANUFACTURER'S STANDARD.
3. AS COMMON PANELS ARE SHARED WHEN THEY ARE GANGED TOGETHER, THE AREA FOR AN INDIVIDUAL WORKSPACE IS BASED ON THE CENTRELINE OF THE PANEL.
4. WORKSURFACES AND STORAGE SHALL HAVE DIMENSIONAL LOGIC AND CONSISTENCY.
5. ALL WORKSURFACES TO BE FREE-STANDING (NON-PANEL HUNG).
6. ALL STORAGE TO BE LOCKABLE AND KEYED ALIKE.
7. COMPONENTS LISTED AS OPTIONAL CAN BE MIXED AND MATCHED, OR OMITTED.
8. CHAIRS ARE SHOWN FOR ILLUSTRATION ONLY.
9. OPTIONAL: GLASS MAY BE ADDED BASED ON PROJECT REQUIREMENTS.

A1. PRIMARY WORKSURFACE

- 30" D x 60" W (762 mm D x 1524 mm W)
- ELECTRIC HEIGHT ADJUSTABLE. DUAL STAGE, PROGRAMMABLE CONTROLLER
- CABLE MANAGEMENT ALONG BACK

B2. SECONDARY WORKSURFACE

- 24" D x 90" W (610 mm D x 2286 mm W)
- PIN HEIGHT ADJUSTABLE POST LEGS (C-LEGS OPTIONAL)
- CABLE MANAGEMENT ALONG BACK

C1. OPEN/CLOSED INTEGRATED WARDROBE AND STORAGE TOWER

- 24" W x 24" D x 54"± H (610 mm W x 610 mm D x 1372 mm ± H)
- FULL WARDROBE WITH COAT ROD INCLUDED
- BOX BOX FILE WITH OPEN SHELVING ABOVE FACING WORKSURFACE B2.
- ANTI-TIP
- SIMILAR OVERALL HEIGHT AS STACKED PANEL

E2. LOW FILE STORAGE (OPTIONAL)

- 36" W x 18" D x 27"± H (914 mm W x 457 mm D x 686 mm ± H)
- 2 DRAWER LATERAL c/w DIVIDERS, LEGAL/LETTER FILE HANGING BARS
- FLUSH BACK AND FINISHED TOP
- ANTI-TIP

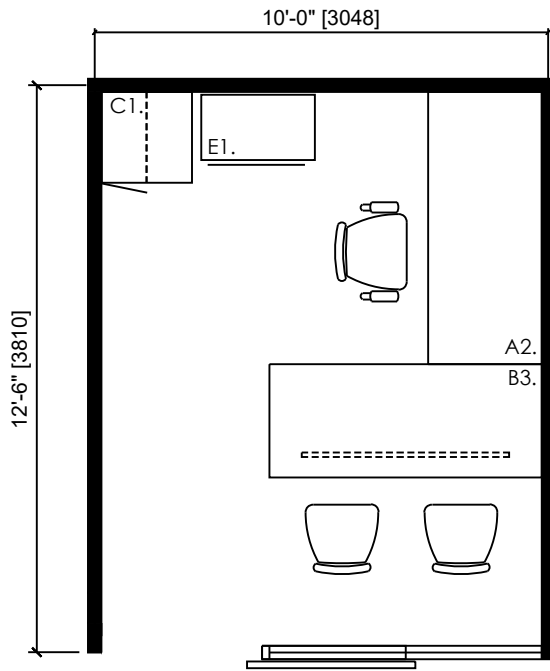

4 EXECUTIVE DIRECTOR (& EQUIVALENT) OFFICE
11.6 m²

FINISHES:

WORKSURFACE TOPS AND TABLE: H.P. PLASTIC LAMINATE C/W STANDARD MATCHING EDGE

LAMINATE: STANDARD GRADE (INCLUDES WOOD GRAIN LAMINATE OPTIONS)

LEGS/BASE: STANDARD PAINTED METAL FINISH (INCLUDES METALLIC OPTIONS)

STORAGE TOWER:

LAMINATE OR STANDARD PAINTED METAL FINISH

STANDARD PULLS (BARRIER-FREE COMPLIANT)

LOW STORAGE:

LAMINATE OR STANDARD PAINTED METAL FINISH

STANDARD PULL - METAL FINISH (BARRIER-FREE COMPLIANT)

WORKSPACE KIT-OF-PARTS LEGEND:

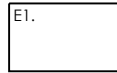
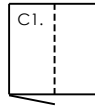
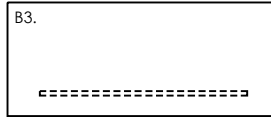
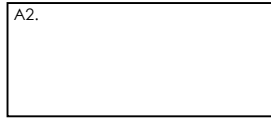

A2. PRIMARY WORKSURFACE

- 30" D x 72" W (762 mm D x 1524 mm W)
- ELECTRIC HEIGHT ADJUSTABLE. DUAL STAGE, PROGRAMMABLE CONTROLLER
- CABLE MANAGEMENT ALONG BACK

B3. SECONDARY WORKSURFACE

- 30" D x 72" W (762 mm D x 1829 mm W)
- ELECTRIC HEIGHT ADJUSTABLE SINGLE STAGE, NON-PROGRAMMABLE CONTROLLER
- HALF HEIGHT 'DETACHABLE' MODESTY PANEL
- CABLE MANAGEMENT ALONG SIDE

C1. OPEN/CLOSED INTEGRATED WARDROBE AND STORAGE TOWER

- 24" W x 24" D x 66" ± H (610 mm W x 610 mm D x 1676 mm ± H)
- FULL WARDROBE WITH COAT ROD INCLUDED
- BOX BOX FILE WITH OPEN SHELVING ABOVE FACING WORKSURFACE A2.
- ANTI-TIP

E1. LOW FILE STORAGE (OPTIONAL)

- 30" W x 18" D x 27" ± H (762 mm W x 457 mm D x 686 mm ± H)
- 2 DRAWER LATERAL c/w DIVIDERS, LEGAL/LETTER FILE HANGING BARS
- FLUSH BACK AND FINISHED TOP
- ANTI-TIP

GENERAL NOTES

1. REFER TO LEGEND SHEET A, AND SECTION 3 OF THE TECHNICAL DESIGN REQUIREMENTS.
2. WORKSURFACES AND STORAGE SHALL HAVE DIMENSIONAL LOGIC AND CONSISTENCY.
3. WORKSPACE IS MEASURED FROM CENTRELINE OF WALL TO CENTRELINE OF WALL.
4. ALL WORKSURFACES TO BE FREE-STANDING (NON-PANEL HUNG).
5. ALL STORAGE TO BE LOCKABLE AND KEYPED ALIKE.
6. COMPONENTS LISTED AS OPTIONAL CAN BE MIXED AND MATCHED, OR OMITTED.
7. CHAIRS ARE SHOWN FOR ILLUSTRATION ONLY.
8. THE OVERALL LENGTH AND WIDTH OF THE ENCLOSED OFFICES MAY VARY TO SUIT SITE CONDITIONS, SO LONG AS THE SPACE REMAINS USEABLE, AND THE SIZE (SQ.M) IS MAINTAINED.

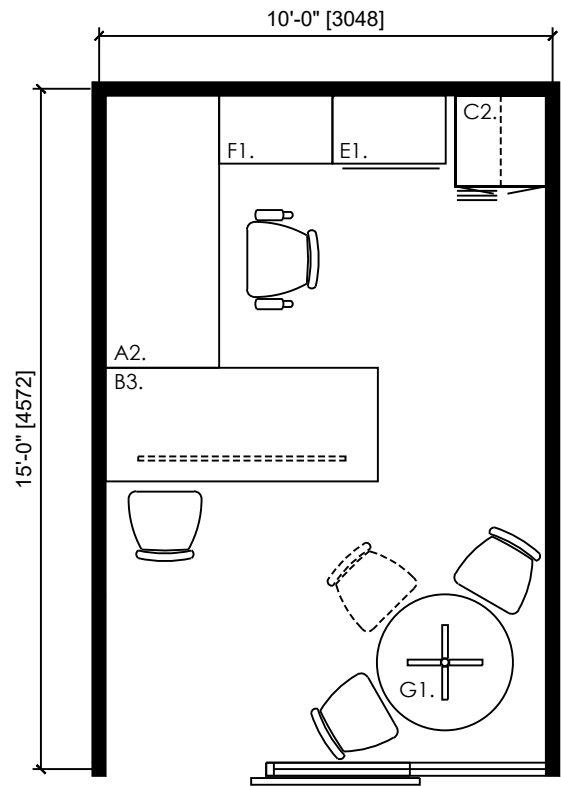

5 ASSISTANT DEPUTY MINISTER (AND EQUIVALENT) OFFICE
14.0 m²

FINISHES:

- WOOD VENEER TOP AND BODY (STANDARD GRADE)
- SQUARE PROFILE EDGE
- FLUSH BACKS AND FINISHED TOPS
- STANDARD METAL PULLS (BARRIER-FREE COMPLIANT)

WORKSPACE KIT-OF-PARTS LEGEND:



A2. PRIMARY WORKSURFACE

- 30" D x 72" W (762 mm D x 1829W)
- ELECTRIC HEIGHT ADJUSTABLE. DUAL STAGE, PROGRAMMABLE CONTROLLER
- CABLE MANAGEMENT ALONG BACK

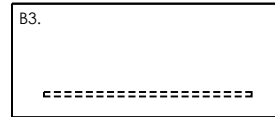

B3. SECONDARY WORKSURFACE

- 30" D x 72" W (762 mm D x 1829 mm W)
- ELECTRIC HEIGHT ADJUSTABLE SINGLE STAGE, NON-PROGRAMMABLE CONTROLLER
- HALF HEIGHT 'DETACHABLE' MODESTY PANEL
- CABLE MANAGEMENT ALONG SIDE

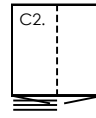

C2. CLOSED INTEGRATED WARDROBE AND STORAGE TOWER

- 24" W x 24" D x 72" ± H (610 mm W x 610 mm D x 1829 mm ± H)
- COAT ROD INCLUDED
- BOX BOX FILE WITH CLOSED SHELVING ABOVE
- ANTI-TIP

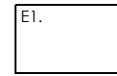

E1. LOW FILE STORAGE (OPTIONAL)

- 30" W x 18" D x 27" ± H (762 mm W x 457 mm D x 686 mm ± H)
- 2 DRAWER LATERAL c/w DIVIDERS, LEGAL/LETTER FILE HANGING BARS
- FLUSH BACK AND FINISHED TOP
- ANTI-TIP

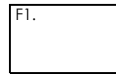

F1. LOW OPEN STORAGE (OPTIONAL)

- 30" W x 18" D x 27" ± H (762 mm W x 457 mm D x 686 mm ± H)
- ONE SHELF
- FLUSH BACK AND FINISHED TOP

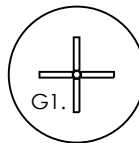

G1. DESK HEIGHT TABLE

- 36" Dia. (914 mm Dia.)
- METAL "X" BASE

GENERAL NOTES

- REFER TO LEGEND SHEET A, AND SECTION 3 OF THE TECHNICAL DESIGN REQUIREMENTS.
- WORKSURFACES AND STORAGE SHALL HAVE DIMENSIONAL LOGIC AND CONSISTENCY.
- WORKSPACE IS MEASURED FROM CENTRELINE OF WALL TO CENTRELINE OF WALL.
- ALL WORKSURFACES TO BE FREE-STANDING (NON-PANEL HUNG).
- ALL STORAGE TO BE LOCKABLE AND KEYED ALIKE.
- COMPONENTS LISTED AS OPTIONAL CAN BE MIXED AND MATCHED, OR OMITTED.
- CHAIRS ARE SHOWN FOR ILLUSTRATION ONLY.
- THE OVERALL LENGTH AND WIDTH OF THE ENCLOSED OFFICES MAY VARY TO SUIT SITE CONDITIONS, SO LONG AS THE SPACE REMAINS USEABLE, AND THE SIZE (SQ.M) IS MAINTAINED.

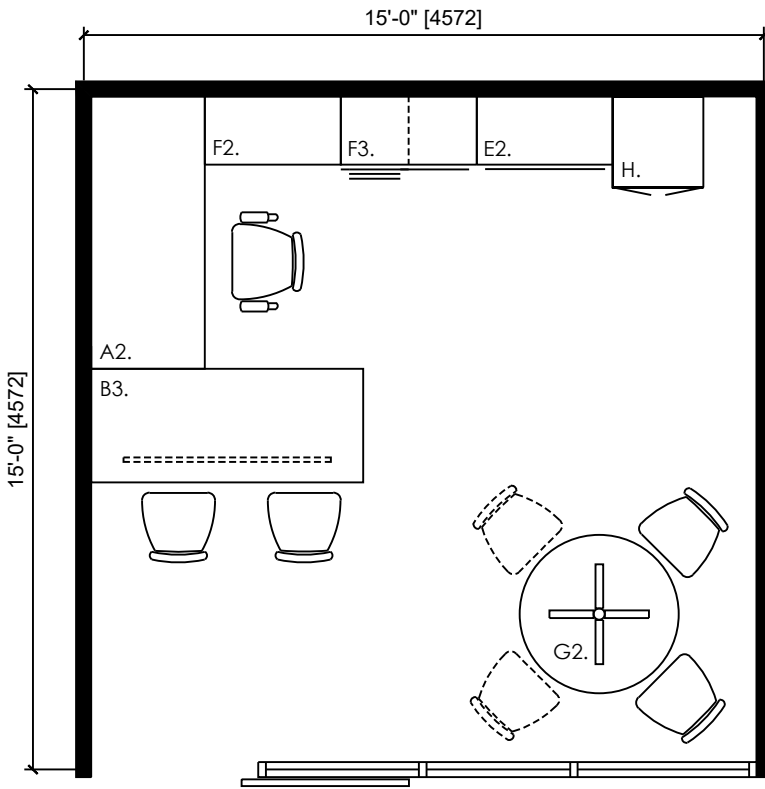

6 DEPUTY MINISTER (AND EQUIVALENT) OFFICE
20.9 m²

FINISHES:

- WOOD VENEER TOP AND BODY (STANDARD GRADE)
- REVERSE CHAMFER EDGE PROFILE
- FLUSH BACKS AND FINISHED TOPS
- UPGRADED METAL PULLS, IF AVAILABLE (BARRIER-FREE COMPLIANT)

WORKSPACE KIT-OF-PARTS LEGEND:

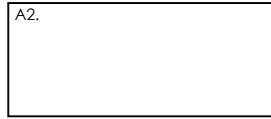

A2. PRIMARY WORKSURFACE

- 30" D x 72" W (914 mm D x 1829 mm W)
- ELECTRIC HEIGHT ADJUSTABLE. DUAL STAGE, PROGRAMMABLE CONTROLLER
- CABLE MANAGEMENT ALONG BACK

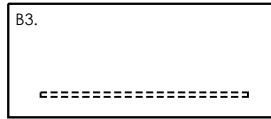

B3. SECONDARY WORKSURFACE

- 30" D x 72" W (762 mm D x 1829 mm W)
- ELECTRIC HEIGHT ADJUSTABLE SINGLE STAGE, NON-PROGRAMMABLE CONTROLLER
- HALF HEIGHT 'DETACHABLE' MODESTY PANEL
- CABLE MANAGEMENT ALONG SIDE

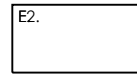

E2. LOW FILE STORAGE

- 36" W x 18" D x 27" ± H (914 mm W x 457 mm D x 686 mm ± H)
- 2 DRAWER LATERAL c/w DIVIDERS, LEGAL/LETTER FILE HANGING BARS
- FLUSH BACK AND FINISHED TOP
- ANTI-TIP

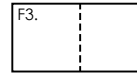
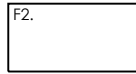

F2. LOW OPEN STORAGE

- 36" W x 18" D x 27" ± H (914 mm W x 457 mm D x 686 mm ± H)
- ONE SHELF
- FLUSH BACK AND FINISHED TOP

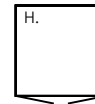
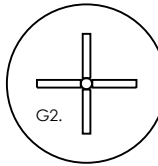

F3. LOW COMBINATION STORAGE

- 36" W x 18" D x 27" ± H (914 mm W x 457 mm D x 686 mm ± H)
- 2 BOX DRAWERS, 1 FILE DRAWER OVER LATERAL FILE DRAWER
- FLUSH BACK AND FINISHED TOP
- ANTI-TIP

G2. DESK HEIGHT TABLE

- 42" Dia. (1067 mm Dia.)
- METAL "X" BASE

H. CLOSED COMBINATION WARDROBE AND STORAGE CABINET

- 24" D x 24" W x 72" H (610 mm D x 610 mm W x 1829 mm H)
- ANTI-TIP

GENERAL NOTES

1. REFER TO LEGEND SHEET A, AND SECTION 3 OF THE TECHNICAL DESIGN REQUIREMENTS.
2. WORKSPACE IS MEASURED FROM CENTRELINE OF WALL TO CENTRELINE OF WALL.
3. WORKSURFACES AND STORAGE SHALL HAVE DIMENSIONAL LOGIC AND CONSISTENCY.
4. ALL WORKSURFACES TO BE FREE-STANDING (NON-PANEL HUNG).
5. ALL STORAGE TO BE LOCKABLE AND KEYS ALIKE.
6. COMPONENTS LISTED AS OPTIONAL CAN BE MIXED AND MATCHED, OR OMITTED.
7. CHAIRS ARE SHOWN FOR ILLUSTRATION ONLY.
8. THE OVERALL LENGTH AND WIDTH OF THE ENCLOSED OFFICES MAY VARY TO SUIT SITE CONDITIONS, SO LONG AS THE SPACE REMAINS USEABLE, AND THE SIZE (SQ.M) IS MAINTAINED.